



# Central Plains Youth Sports

This is our second Newsletter this year. The March newsletter brought us some positive news for the project. We received an anonymous pledge to provide approximately \$40,000 worth of materials to help build the parking lot.

April 2012  
Issue 2

If others would like to help with this project our priority one needs are to build a parking lot:

- Asphalt and concrete materials
- Curb and guttering help
- Trucking for fly ash
- Finished Grading

Any donations from \$50 and above would be greatly appreciated for any of the work in kind items mentioned above or cash donations.

If you know of anyone that might be interested in helping us with these immediate needs please send this newsletter to them.

This community facility will be host to up to **250,000** athletes and their spectators annually. We anticipate that a half million people will flow through this facility each year.

Please consider joining us as we put our "Road To Success" into place and build this wonderful facility for our kids.

Editor: Margo Landis 841-3699

### Volunteers:

- Margo Landis
- Jan Worley
- Dennis Emrich
- Janet Emrich
- Brian Black
- Ryan Holmes
- Sam Kerns
- Steve Turkle
- Dr. Marci Johnson
- David Poynter
- Randy Belles
- Larry Pecenka
- Tom Tilma
- Mike Marasco
- Phil Svymbersky
- Steve Stelljes

### Partners:

- APAC-Kansas,  
Jim Ralston
- Anonymous work in kind
- Pledge for the Parking lot
- The City of Wichita
- Spirit AeroSystems,  
Steve Turkle
- MKEC, Jason Gish
- Wichita Sports  
Commission,  
Bob Hanson
- Snappy Photo,  
Phil Svymbersky
- IAM, Kathy S. Petersen
- IBEW, Jim Davis
- SPEEA, Debbie Logsdon
- KFDI, John Wright, Jr.

## It's all about the kids



We are proud of our teams of volunteers that help with building marketing material, providing web management, supporting project development, and increasing awareness in the community.

We had our second volunteer meeting this month. In our volunteer meetings we have taken some of our first steps towards "The Road to Success". This consisted of updating our communication lists, researching foundations and implementing our strategy, all to support:

### "The Road to Success"



If you are interested in joining our volunteer team, no invitations are required. Contact us at: [galen@cpys.org](mailto:galen@cpys.org) or call 316 371-8615.



As we mentioned in our March newsletter; **our vision** is to build 18 Baseball and Softball fields and make them available to teams and kids in south-central Kansas.



Each field can accommodate **240** softball or baseball players each year and for each year after that. Upon completion of the entire facility, up to **4,000** kids will be able to participate each week.



Just a reminder as to what we have already accomplished

**To date** we have committed approximately \$800,000 in resources: To provide Architectural concepts and designs as well as Civil Engineering.

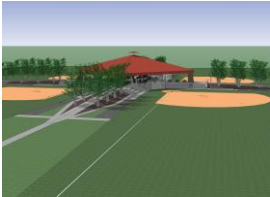
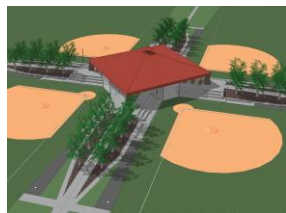

For Site grading - Dirt has been moved to the appropriate elevation to support optimum drainage.



For installation of Storm sewer, water and field drainage pipes infrastructure – Lake is in place



## Next activities – build fields and parking lot

**Central Plains Youth Sports is urgently requesting help for completion of this facility for the summer Baseball and Softball season in 2013.**

In addition to the parking lot needs, If you know of anyone or any company that might consider an offer to donate funding or work-in-kind to go towards providing Fencing for the fields, Sod & Sprinkler systems please share this with them.